

U.S. AIR FORCE JET BOMBER **B-47E STRATOJET™**

● EASY TO ASSEMBLY ALL-PLASTIC SCALE MODEL ● SCALE 1/72 ● SPAN 490mm ● LENGTH 475mm
● HEIGHT 127mm ● ENGINE SIX JET ENGINES

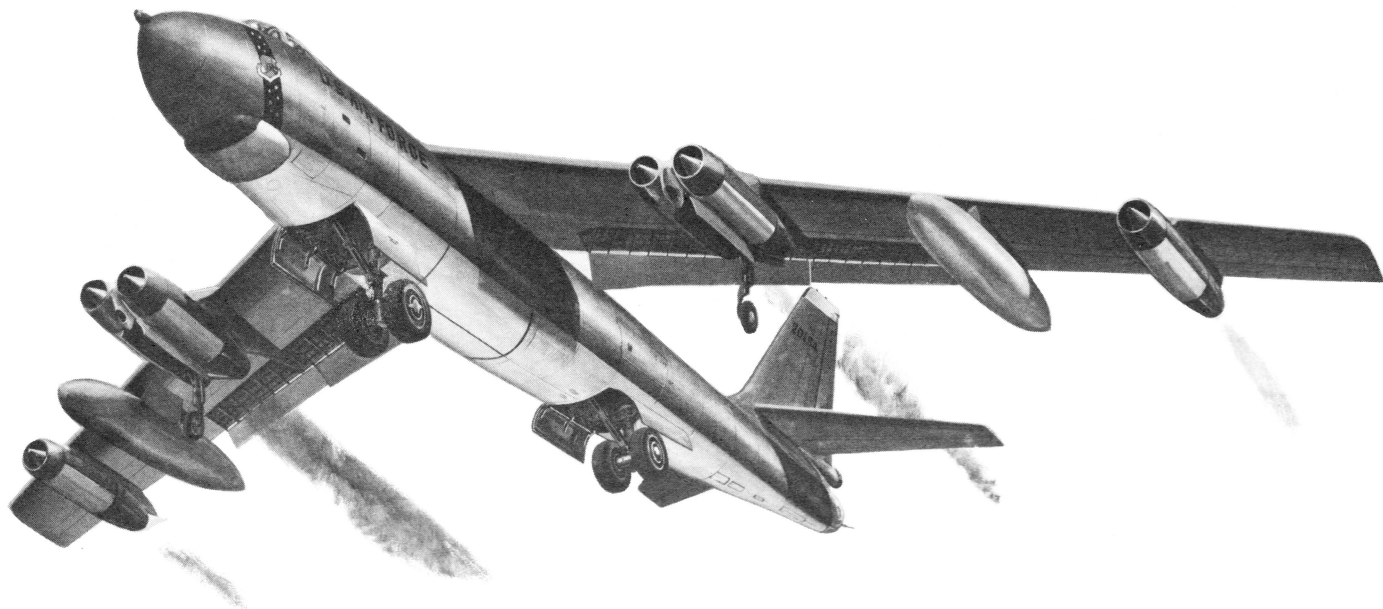

B-47E STRATOJET

Boeing Company first started its work on jet bombers at the end of 1943. First trial model was ordered in April 1946 and its first model called XB-47 was completed 18 months later. At the time, Boeing's most latest technique included a design such as suspending engines on slim and long main wings with 35 degrees angle to neutralize the torsional straining moment. This same model of B-47E took its first flight in 1953, using J47-GE-25 with the thrust of 2,700 kgs. and rear armament included GE's radar-controlled two 20mm-twin-guns. Ejection seat was equipped for crew. It also has JATO type take-off acceleration rocket and parachute of 4.88m diameter for landing brakes; its total take-off weight reached 91 tons. But the defects found in this aircraft shortened its life. For example, landing gears in the bow and aft required both gears to touch the ground at the same time which narrowed the limit of weight movement. Pilot seats in front and back were not reputable; dwelling was bad and degree of fatigue was big. Even then, it was the first class jet bomber in the period of 1940-1950 and must leave its big name in the history of air.

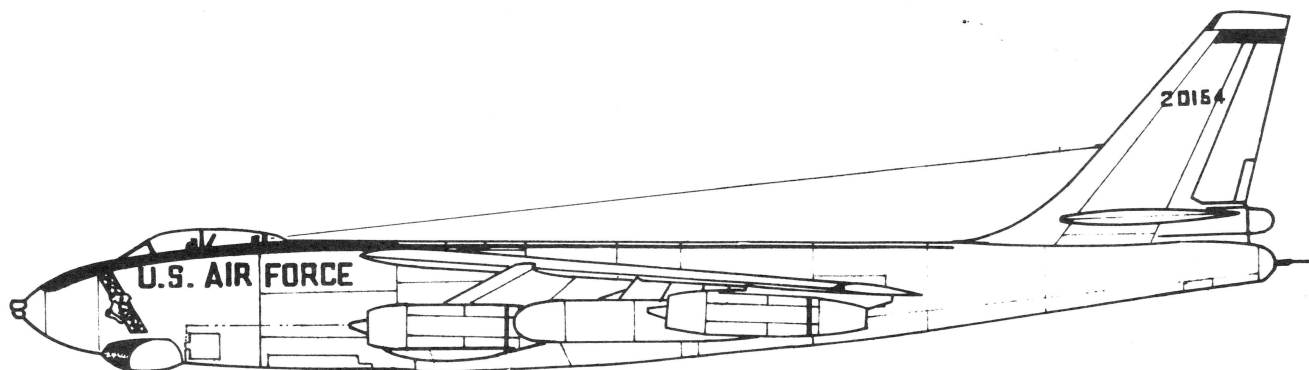

HASEGAWA SEISAKUSHO CO., LTD.

1193-2 Yagusu. Yaizu. Shizuoka. 425 Japan.

Read these instructions carefully before assembling your model and check the exact fit of the parts before cementing. Clean off excess plastic, if any, with a sharp knife or a file. Since many tiny parts are included, check them with the assembly drawing before assembling. Do not tear off parts from the stem, but cut them off carefully with nippers or tin snips. Do not cut off all of the parts at the beginning, but cut each part to be assembled one by one to assure each part being properly identified. Do not use too much adhesive because surplus adhesive will spoil the appearance.

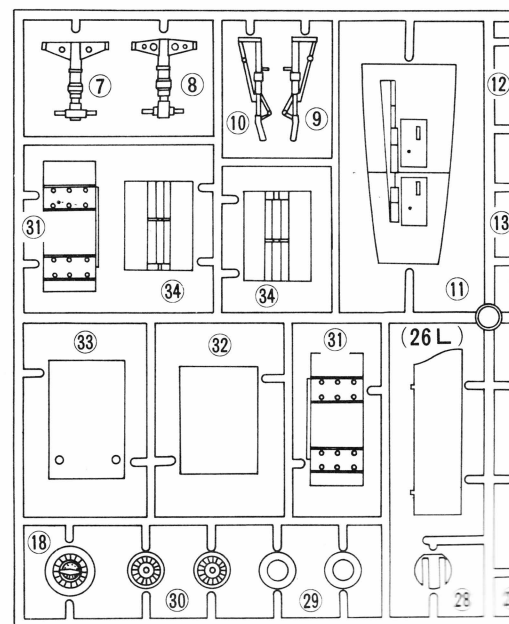
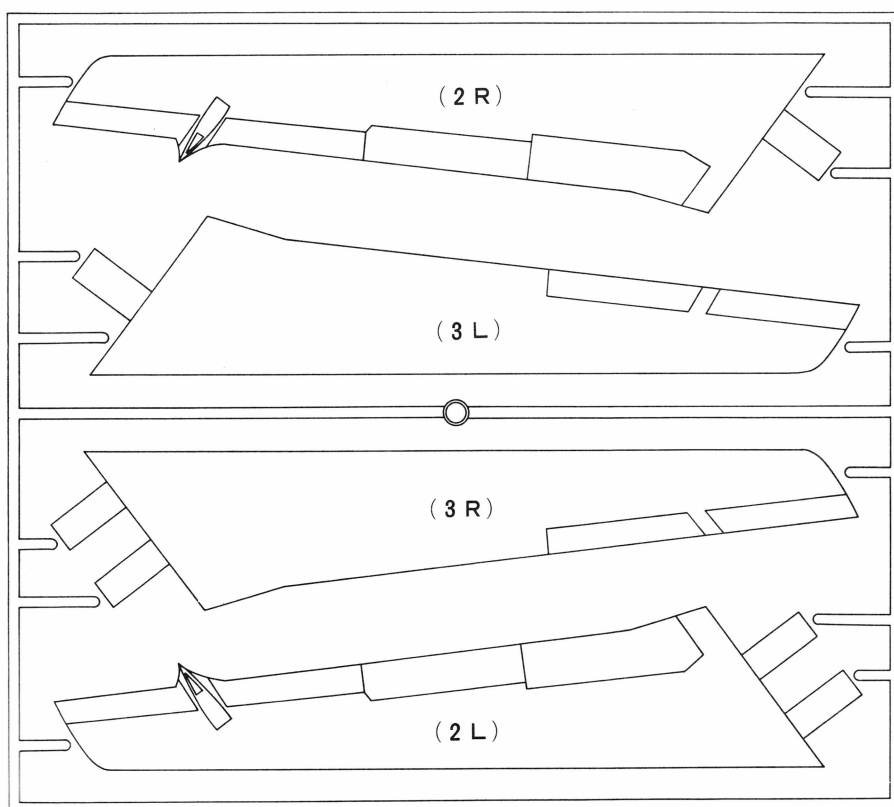
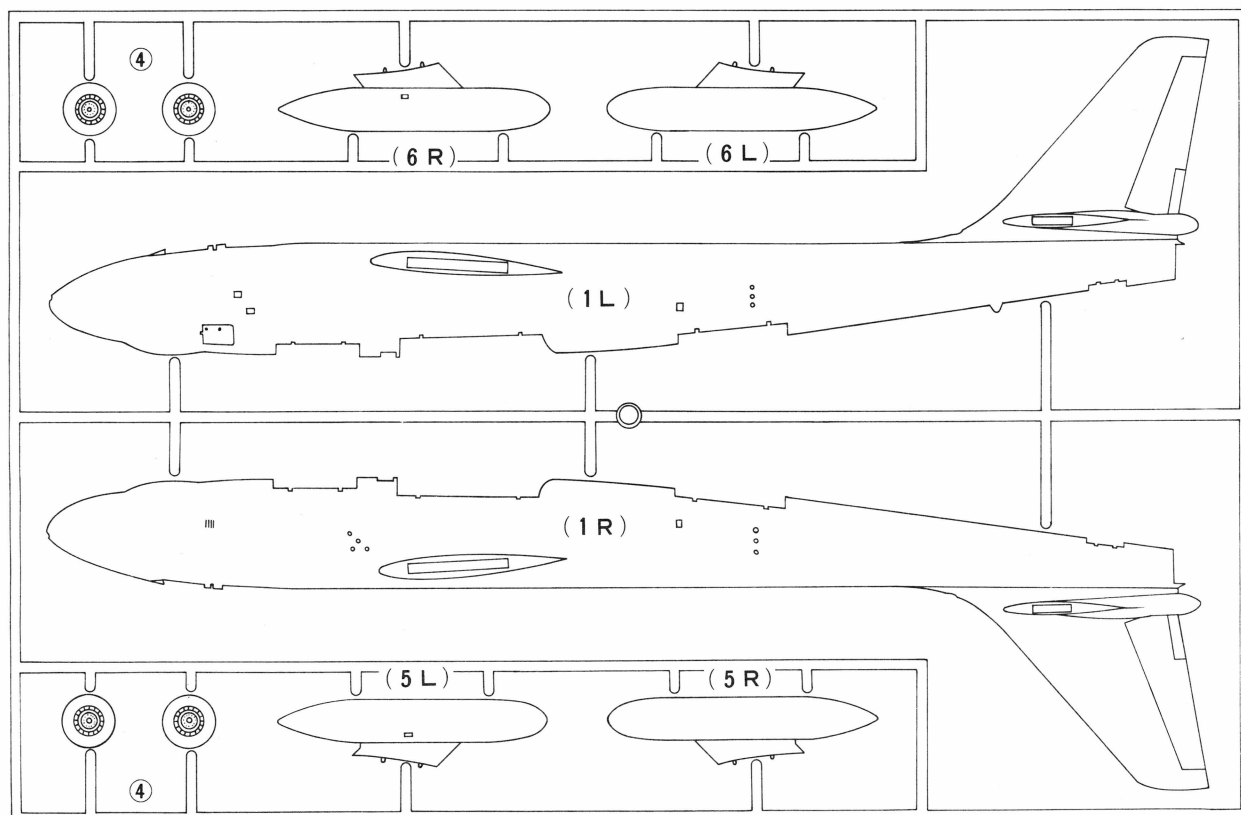

1

Fuselage and cockpit assembly.

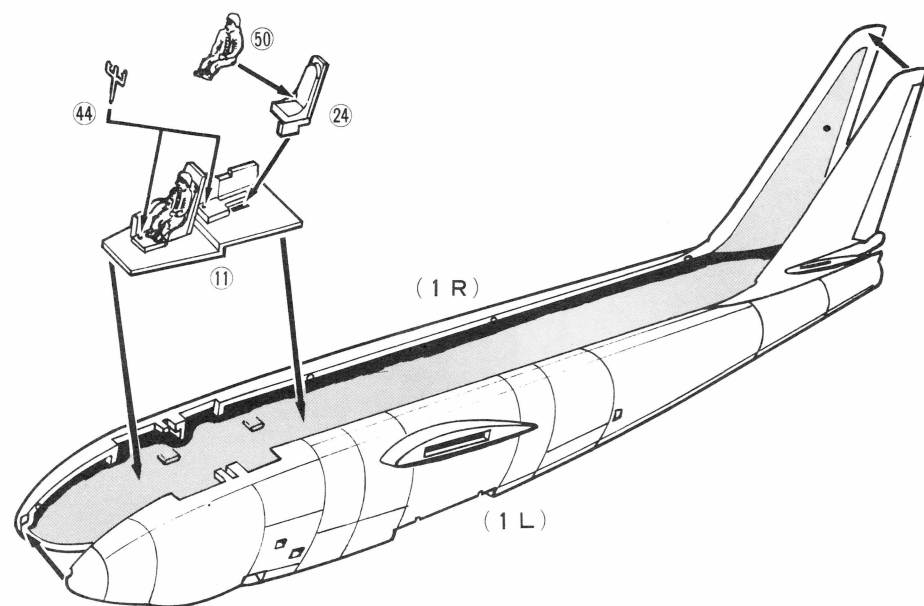

4

Bomb assembly.

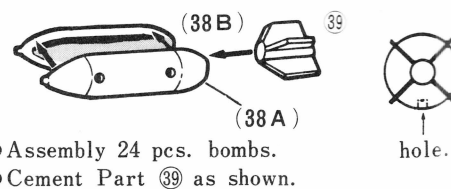

- Assembly 24 pcs. bombs.
- Cement Part 39 as shown.

5

Fixing of bombs to shackle.

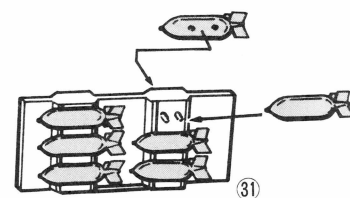

- Fix 24 pcs. bombs to 2 shackles.

7

Main wing, tail plane, canopy and other assembly.

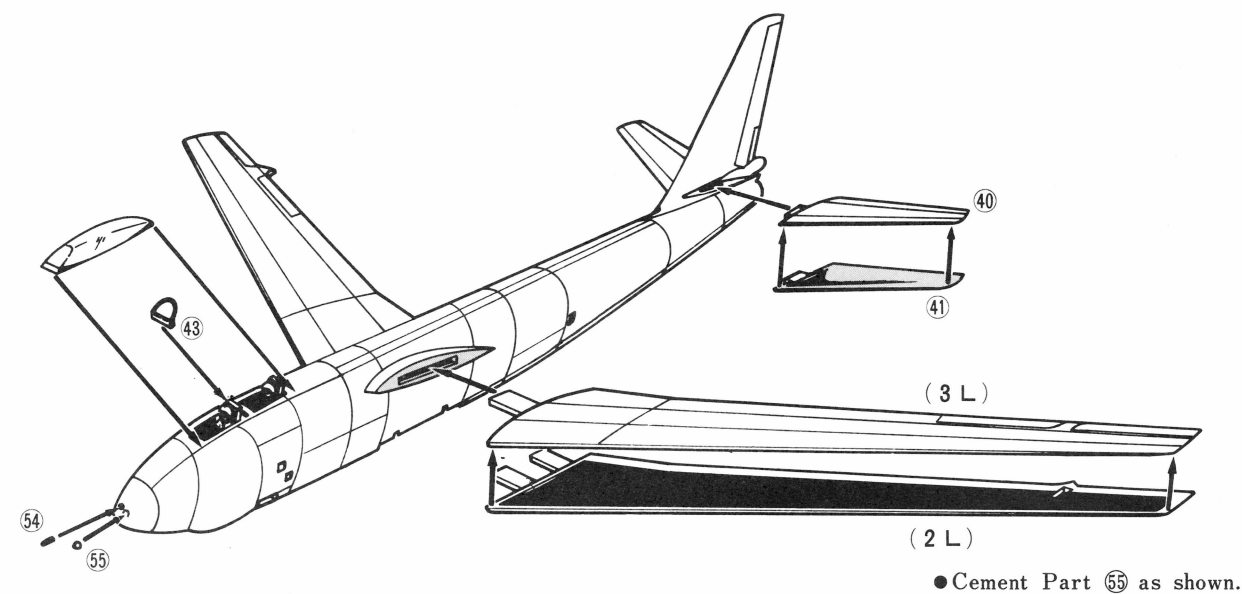

- Cement Part 55 as shown.

2

Front gear assembly.

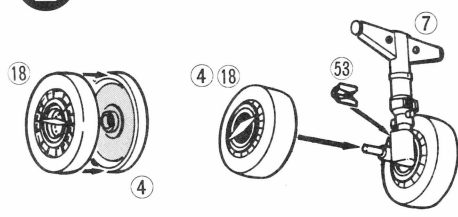

3

Rear gear assembly.

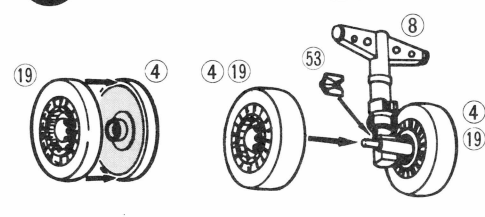

6

Auxiliary landing gear assembly.

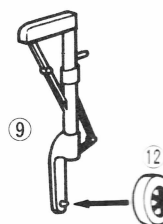

- Parts 9 12 for left wing.
- Parts 10 12 for right wing.

8

Tank assembly.

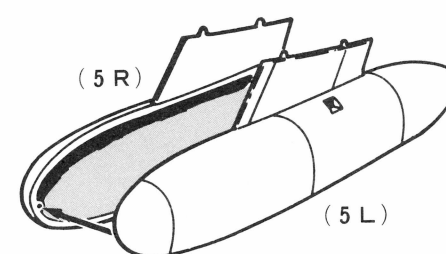

- Above shows tank for left wing.
- Also assemble tank (6L). (6R) for right wing.

9

Outboard engine nacelle assembly.

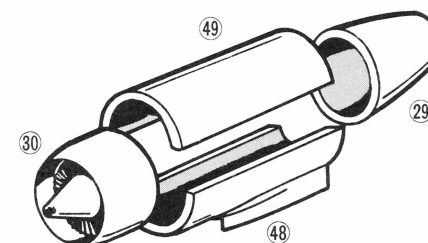

- Assemble 2 set.

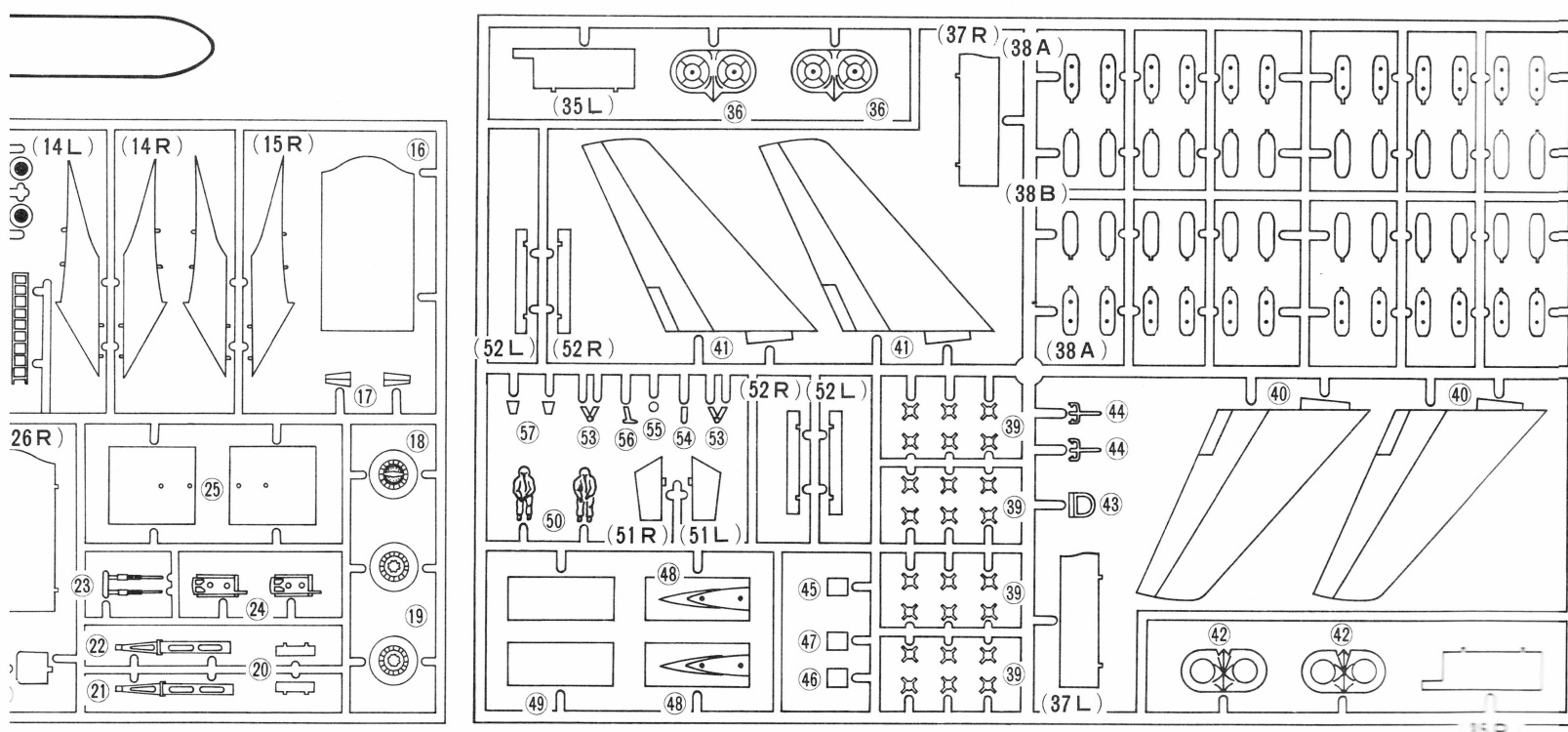

10

- Also assemble (15L) (15R)
for right wing. (14R)
-
- (14L)
- (25)
- (36)
- (42)
- (34)
- See number
underneath Part (34)
Cement younger number

● See number underneath Part ③④
③④ Cement younger number to Part ③⑥.

11

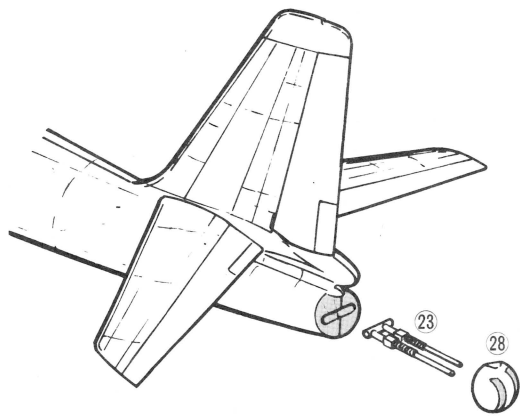

12

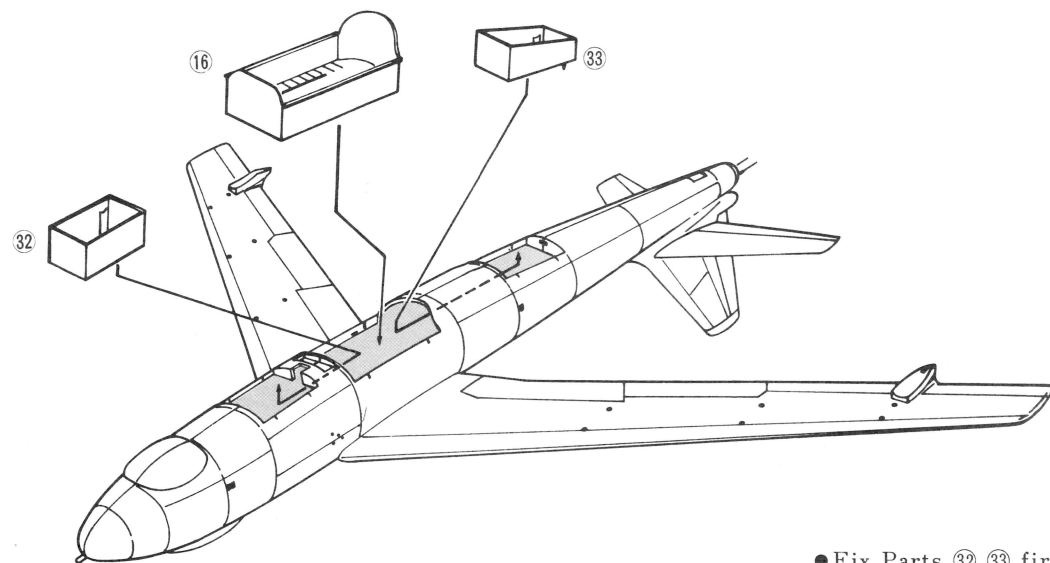

- Fix Parts ③② ③③ first and then Part ①⑥.

13

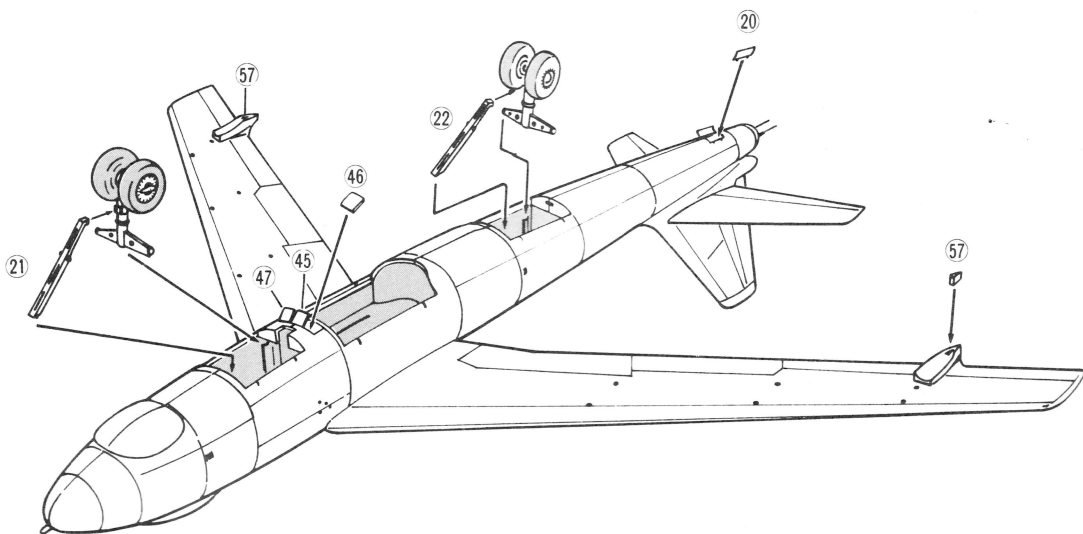

Reference drawing of decals and painting.

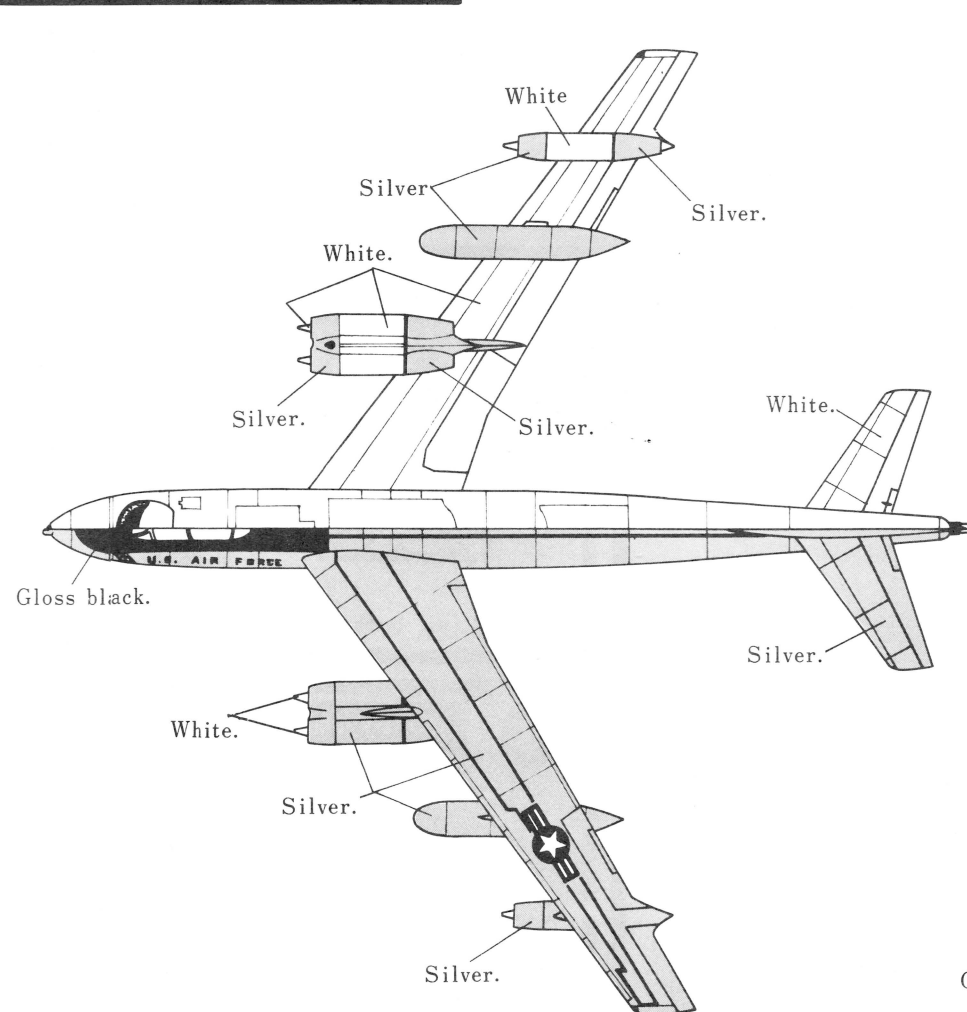

Red.

White.

Black

20164

Fuselage, upper sideSilver
 Fuselage, bottom sideWhite.
 Wing, upper sideSilver
 Wing, bottom side.....White
 TankSilver
 Engine NacelleSilver
 Inside cockpitDark Green

White.

White.

Silver.

Red.

U.S. AIR FORCE

Right yellow.

Gloss black.

Gloss black.

14

-

15

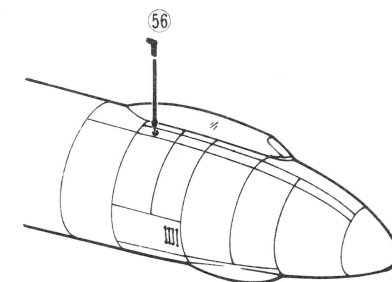

16

